

4

3

2

1

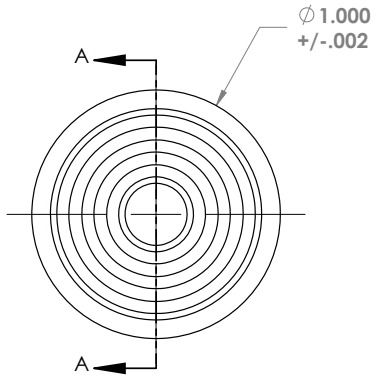

ϕ 1.000
+/- .002

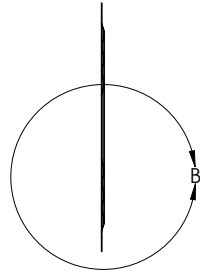

SECTION A-A

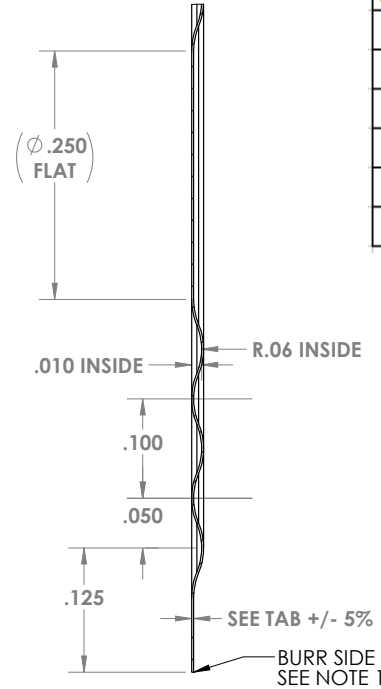

DETAIL B
SCALE 8 : 1

| REV | DESCRIPTION | DATE | INITIALS |
|-----|---------------------------------|-----------|----------|
| C | DEFLECTION CALCULATIONS UPDATED | 7/21/2017 | JD |
| | | | |
| | | | |
| | | | |
| | | | |

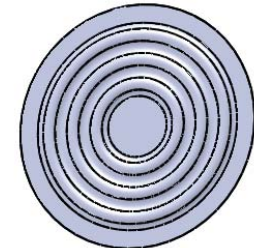

GENERAL NOTES:

- 1) BURR TO BE 30% OF MATERIAL THICKNESS
- 2) MAX CAMBER (POTATO CHIPPING) OF 2% OF OD
- 3) ALL RIPPLE DIMENSIONS IN VIEW B ARE TOOL CONTROLLED
- 4) MANUFACTURE DIAPHRAGM FROM TOOL T-HSLP-1.000
- 5) DINGS AND DENTS ACCEPTABLE IF DETECTED ON ONE SIDE ONLY
- 6) DIAPHRAGMS TO BE NESTED AND PACKED TO AVOID DAMAGE

| TAB | Part Name | Diameter | Thickness | Material | Specification | Deflection * |
|-----|--------------------|----------|-----------|----------|---------------|--------------|
| -1 | HSLP1.000-0020-316 | 1.000 | 0.002 | SS316L | AMS-5507 | 0.0033 |
| -2 | HSLP1.000-0020-718 | 1.000 | 0.002 | IC718 | AMS-5596 | 0.0031 |
| -3 | HSLP1.000-0030-316 | 1.000 | 0.003 | SS316L | AMS-5507 | 0.0017 |
| -4 | HSLP1.000-0030-625 | 1.000 | 0.003 | IC625 | AMS-5599 | 0.0015 |
| -5 | HSLP1.000-0030-718 | 1.000 | 0.003 | IC718 | AMS-5596 | 0.0016 |

* Deflections listed at 1.0 psi are simulated results. Actual results may vary.

UNLESS OTHERWISE SPECIFIED:
DIMENSIONS ARE IN INCHES
TOLERANCES:
FRACTIONAL ± 1/32
ANGULAR: MACH ± BEND ±
TWO PLACE DECIMAL ± .015
THREE PLACE DECIMAL ± .005
INTERPRET GEOMETRIC
TOLERANCING PER: ASME Y14.5M94
DO NOT SCALE DRAWING

| | | |
|---|---------|---|
| NAME | DATE | TITLE: Metal Diaphragm |
| DRAWN WAGNER | 9-21-15 | |
| CHECKED DEBONE | 9-22-15 | |
| ENG APPR. | | |
| MFG APPR. | | |
| <p>PROPRIETARY AND CONFIDENTIAL THE INFORMATION CONTAINED IN THIS DRAWING IS THE SOLE PROPERTY OF HUDSON TECHNOLOGIES. ANY REPRODUCTION IN PART OR AS A WHOLE WITHOUT THE WRITTEN PERMISSION OF HUDSON TECHNOLOGIES IS PROHIBITED.</p> | | SIZE B DWG. NO. HSLP1.000-TAB REV C |
| SCALE: 2:1 WEIGHT: | | SHEET 1 OF 1 |

4

3

2

1